

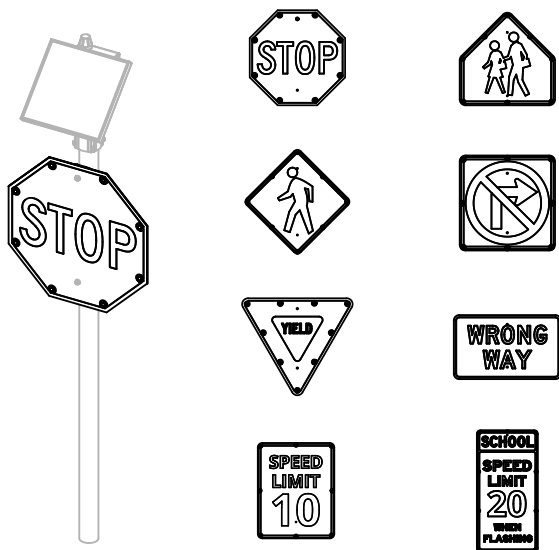

carmanah® MX LED SIGN MODULE MX Series

INSTALL GUIDE

LEVEL 3



① LED sign module package contents

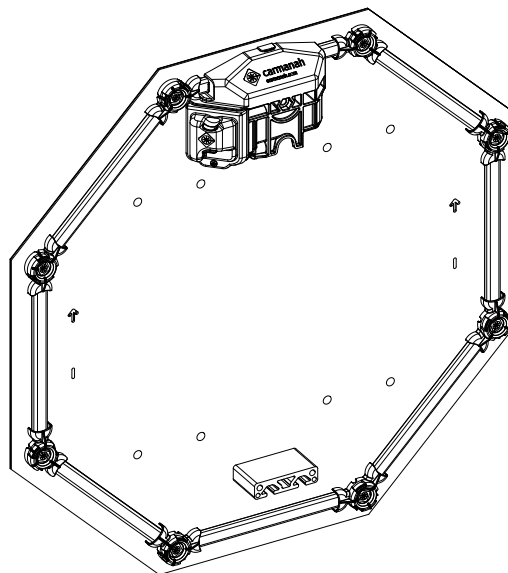

② Mounting options (hardware for mounting sign to pole not included)

a. Through-bolting

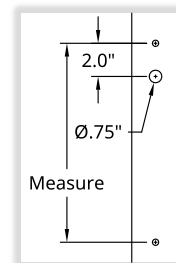
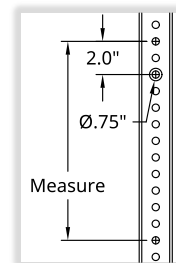
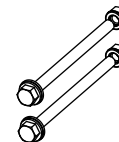

OR

b. Banding

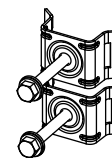

OR

c. Z-bars

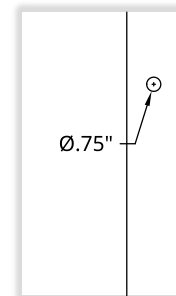
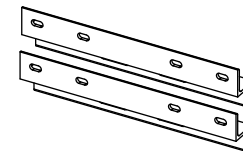

②a. Through-bolting

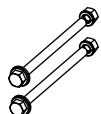

Remove and discard shipping fasteners

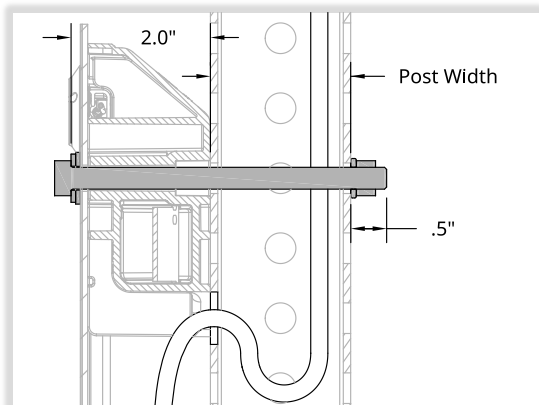
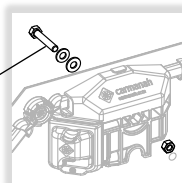

Route cable from power module, forming drip loop as shown.

②b. Banding

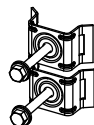

Remove and discard shipping fasteners

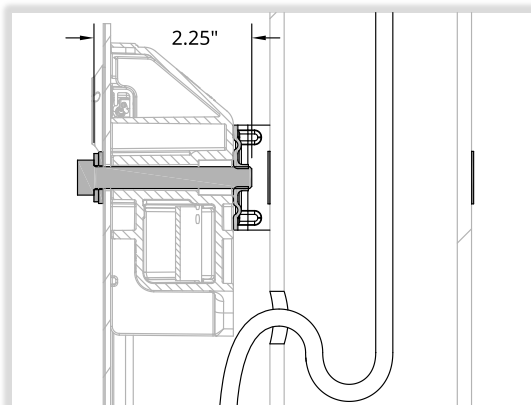
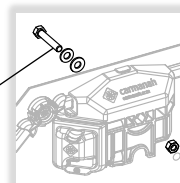

Route cable from power module, forming drip loop as shown.

②c. Z-bars (see Z-bar **LEVEL 4** kit installation guide)

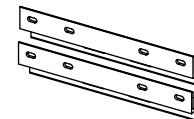

Leave shipping fasteners in place

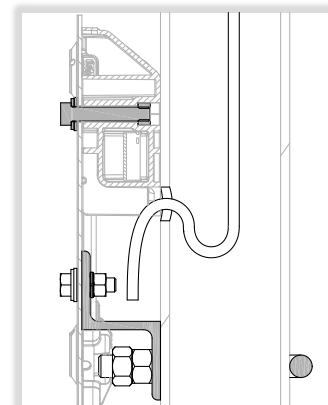
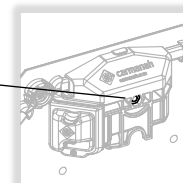

Route cable from power module, forming drip loop as shown.

- ③ Route cable as shown. Strip jacket 2.5" to 3". Note jacket end position.

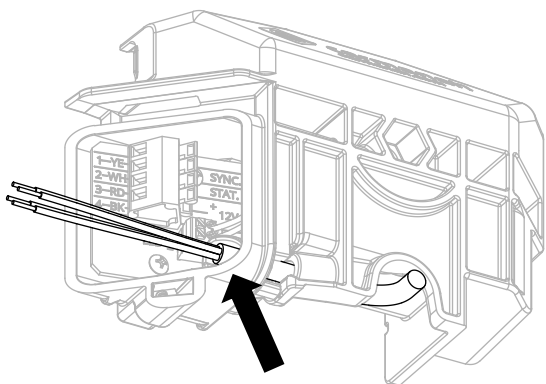

- ④ Wire power module to LED Sign

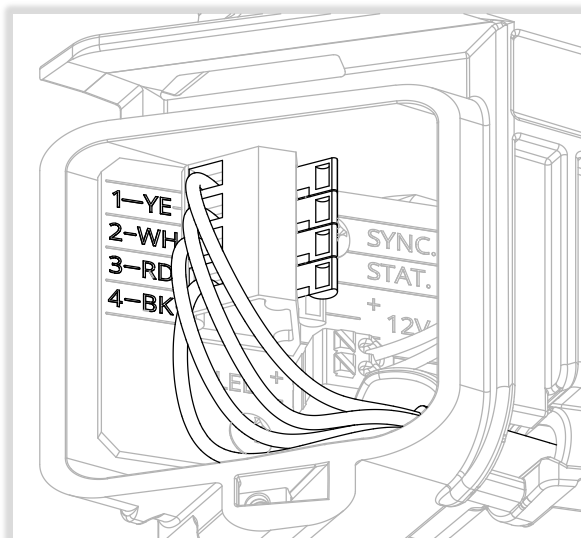

- ⑤ Install cable tie

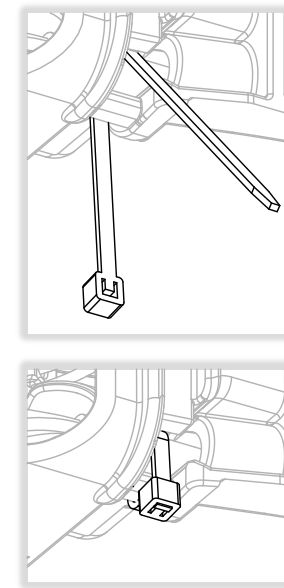
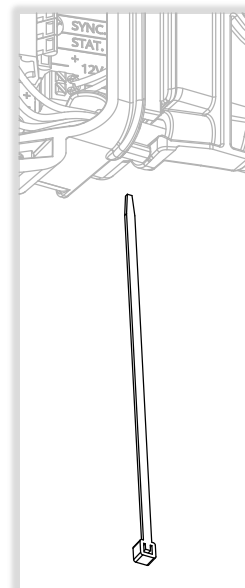

- ⑥ Check wires and gaskets

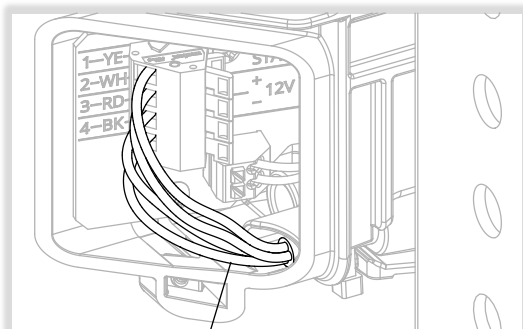

Ensure wires are clear of sealing face and gaskets are in place

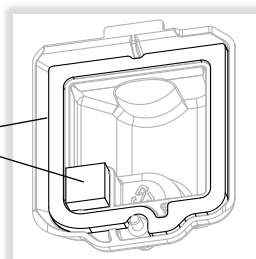

- ⑦ Install cap and tighten screw

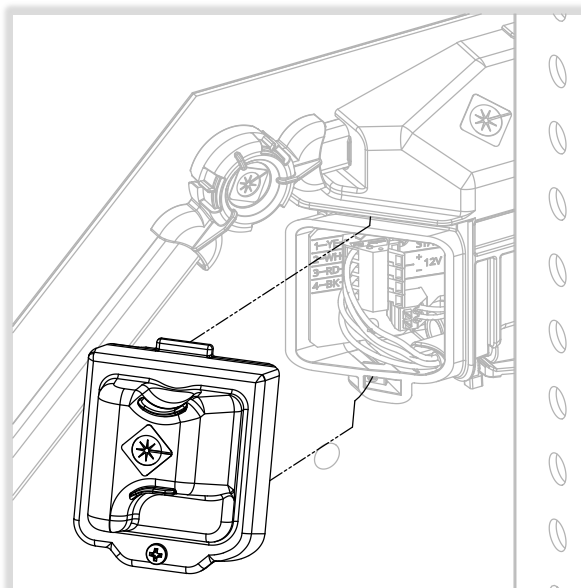

TO COMPLETE SETUP: Use MX Field App to program/link modules and change default settings. Download: carmanah.com/app



FOR REMOTE ACCESS: Log into MX Cloud: MXcloud.live

Maintenance

Periodically clean the surface of the product with water and a soft cloth. A mild non-abrasive cleanser can be used for more stubborn residue. Clean more frequently during drier months. Check for any damaged, missing or broken hardware.

Warranty

This product is covered by the Carmanah warranty. Failure to comply with the use, storage, maintenance or installation instructions detailed in the supplied documentation could void the warranty.

Email: customersupport@carmanah.com
Toll Free: 1.877.722.8877 (US & Canada)
Worldwide: 1.250.380.0052
Web: carmanah.com

**NOTE: READ ALL INCLUDED INSTALL GUIDES
BEFORE SYSTEM INSTALLATION**