

1. Disconnect solar connector and then battery connector(s).

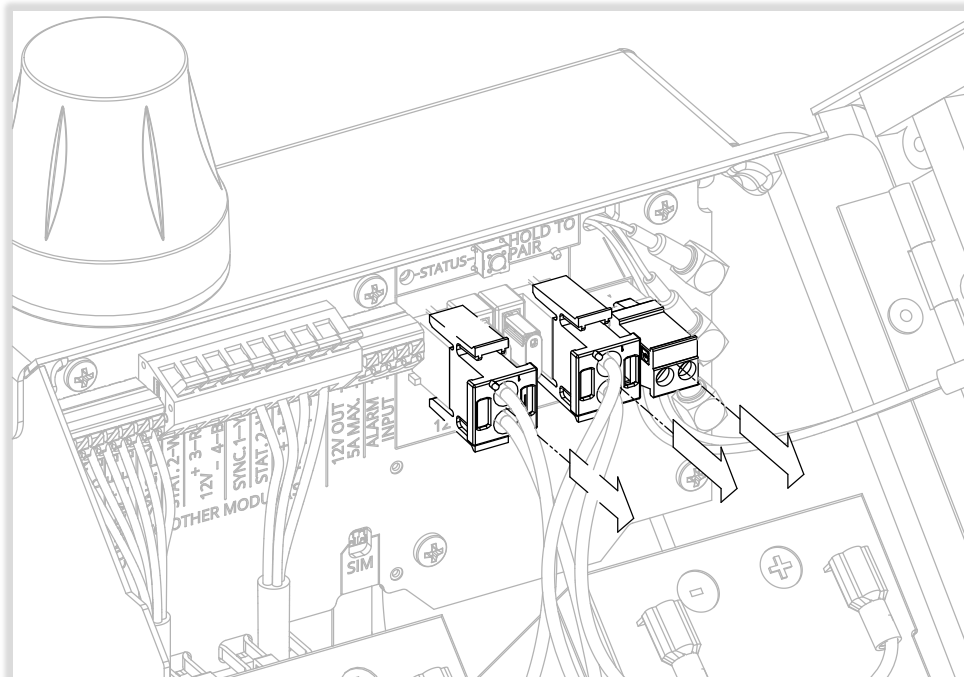

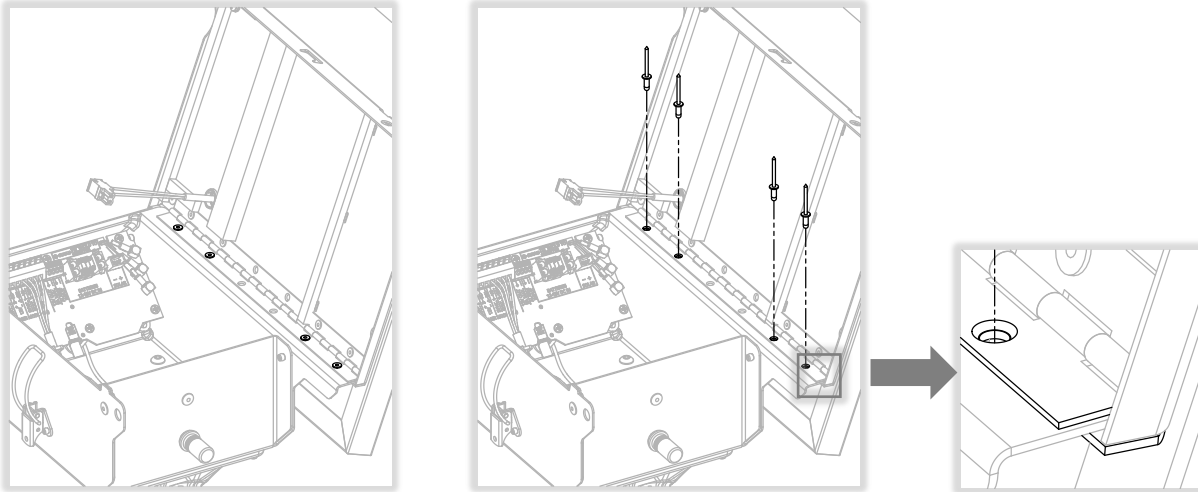

2. Drill out four rivets securing solar panel assembly to MX 100 chassis, using a 0.161" drill bit.
3. Ensure all rivets have been cleared from mounting holes and all metal debris has been removed from MX 100 chassis.
4. Fit replacement MX 100 solar panel assembly in the same manner using included rivets.
5. Ensure rivets protrude completely through MX 100 chassis before riveting.
6. Ensure housing flange is between lid flange and hinge.



NOTE

Ensure housing flange is between hinge leaf and lid flange before riveting.

7. Reconnect battery connector(s).
8. Ensure you have enough slack with solar harness and reconnect to circuit board.
9. Close, latch and lock MX 100.

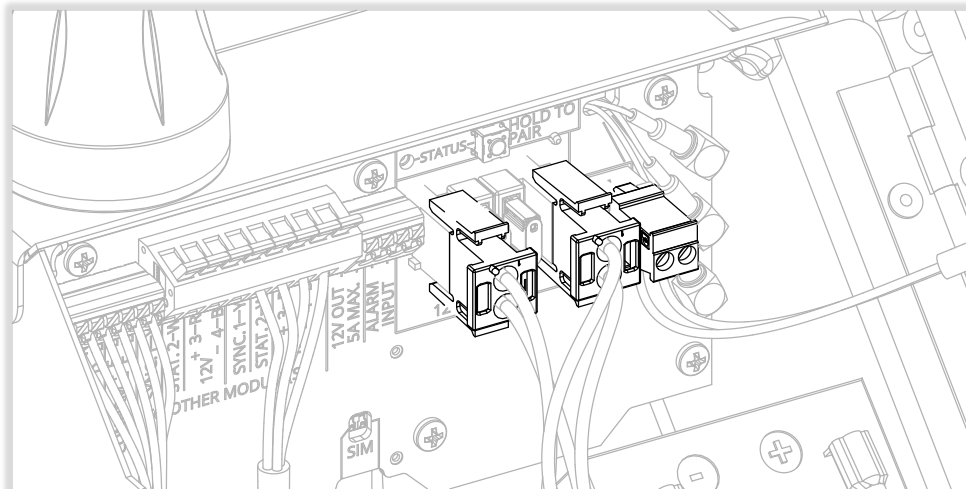

NOTE

Check MX Field App to ensure solar panel is producing suitable voltage.